

KVR 3015 E2 40

135000

- Backward curved radial impeller
- Removable fan unit
- Housing made of galvanized sheet steel
- Robust single phase AC motor, steplessly controllable
- Conveyed medium temperature up to 70 °C in continuous operation



MAP

Name	Value	Unit
Volume flow	0	m³/h
Pressure	0	Pa

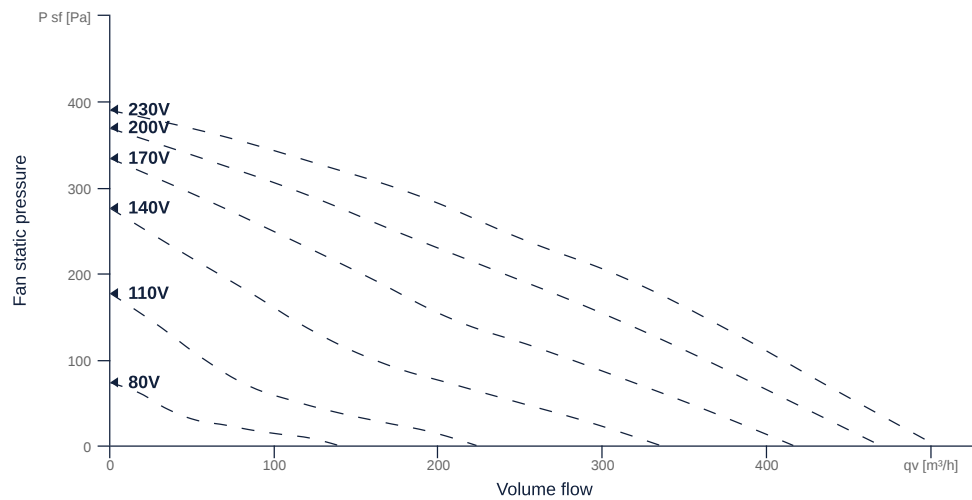

to the product detail page

KVR 3015 E2 40

135000

ruck

GENERAL DATA

Name	Value	Unit	Formula symbol
Certifications	CE, UKCA		
Duct size	300x150		WxH _{duct}
Pipe connection size (DN)	-		DN
Rated voltage (entire device)	230	V	U _{rated}
Phases (entire device)	1~		phase
Electrical protection (entire device)	6 A		fuse
Housing material	Galvanized steel		mat _{casing}
Impeller material	Plastic		mat _{impeller}
IP-protection class (entire device)	IPX4		IP _{compl}
IP-Protection class (terminal box)	IP44		IP _{ebox}
Weight	6.13	kg	m
Nominal air flow rate, nominal point m ³ /h	396	m ³ /h	q _{v,nom}
Nominal external pressure, static	114	Pa	p _{s,nom}
Fan type	Radial		Fan _{type}
Category / Installation situation	A		cat

ERP DATA (LOT 6)

Name	Value	Unit	Formula symbol
Nominal air flow rate, nominal point m ³ /s	0.11	m ³ /s	q _{v,nom}
Actual electrical input power, nominal point	0.05	kW	P _{e,nom}
Face velocity, nominal point	2.44	m/s	v _{nom}
Nominal external pressure, static	114	Pa	p _{s,nom}
supply air fan static efficiency, nominal point	29.1	%	η _{es,SUP}
Enclosure sound level, nominal point	58	dB(A)	L _{WA2}
Rating	Product is compliant 2018		



KVR 3015 E2 40

135000

ruck

MAXIMAL DATA

Name	Value		Unit	Formula symbol
	50 Hz	60 Hz		
Max. power consumption (device)	52	65	W	P _{ed, max}
Max. operating current (device)	0.3	0.37	A	I _{ed, max}
Max. speed	2700	3080	1/min	n _{max}
Max. stat. efficiency	31.7	27.6	%	η _{es}
Max. fan efficiency	32.1	27.7	%	η _e
Max. flowrate	500	535	m ³ /h	Q _{v, max}
Max. stat pressure	390	510	Pa	p _{st, max}
Max. medium temperature	70	70	°C	T _{m, max}
Max. environment temperature	70	70	°C	T _{amb, max}
Min. environment temperature	-25	-25	°C	T _{amb, min}
Min. voltage	80	80	V	U _{min}
Stall current	0.37	0.37	A	I _{LRA}

MOTOR DATA

Name	Value		Unit	Formula symbol
	50 Hz	60 Hz		
Rated frequency (device)		50		f
Motor type		AC 1~		phase
Control type		stepless-controlled		ctrltype
Installation type		ORM (Out)		install
Rotation direction		right		rotation
Isolation class		ISO F		ISOclass
Motor-protection		TMI		protectmotor
Protection class		IP33		IP _{motor}
Is pole-changeable		No		polexch
Type of power supply		AC 1~		pwr _{sup} motor
Capacity capacitor		2	μF	C _{cond}
Voltage capacitor		400	V	V _{Ucond}
Number of poles (1)		2.000000		num poles _{w1}
Rated voltage	230		V	U _{rated, f1}
Rated current	0.23		A	I _{rated, f1}
Speed	2373		1/min	n _{f1}
Efficiency	27.7		%	η _{m, f1}
Min. temperature	-30		°C	T _{motor, min}
Cos Phi	0.990000	0.000000		cos φ
UL-Certification motor		None		ULcert



to the product detail page

KVR 3015 E2 40

135000

CIRCUIT DIAGRAMS / DIMENSIONAL DRAWINGS

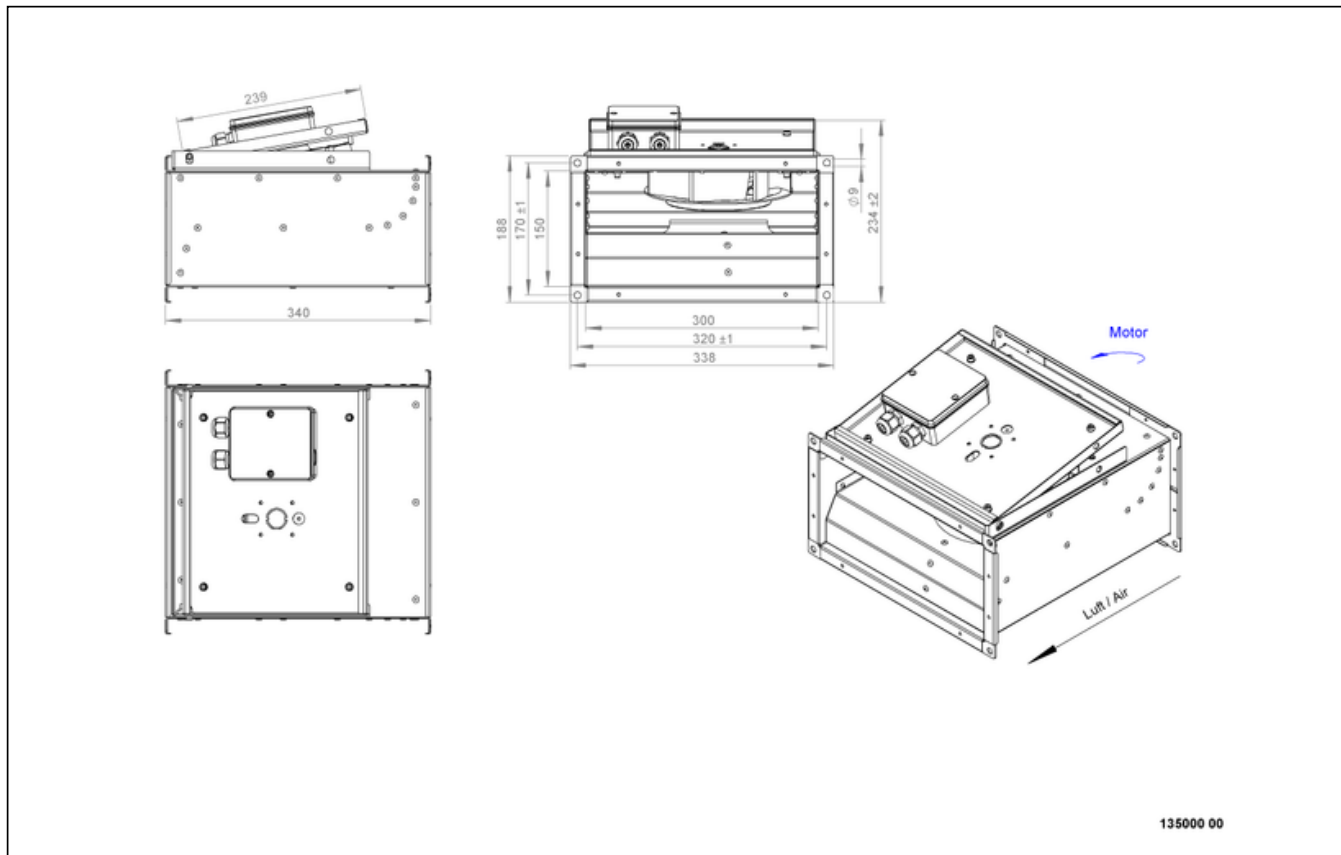

KVR 3015 E2 40

135000

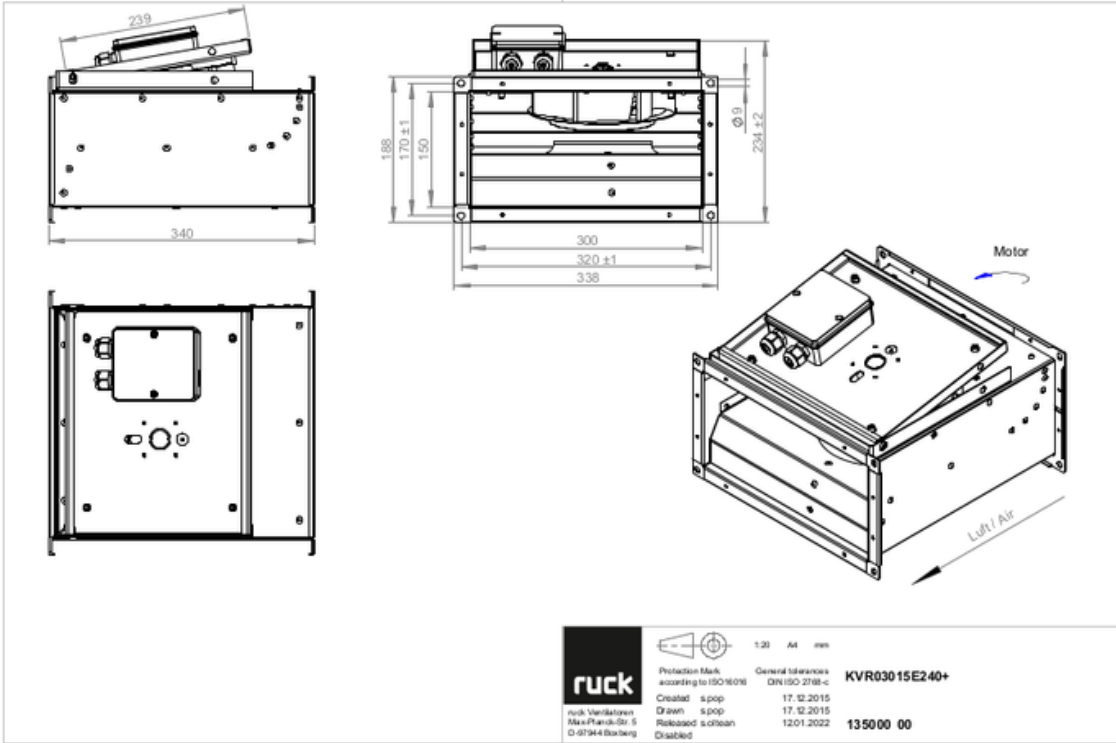

KVR 3015 E2 40

135000

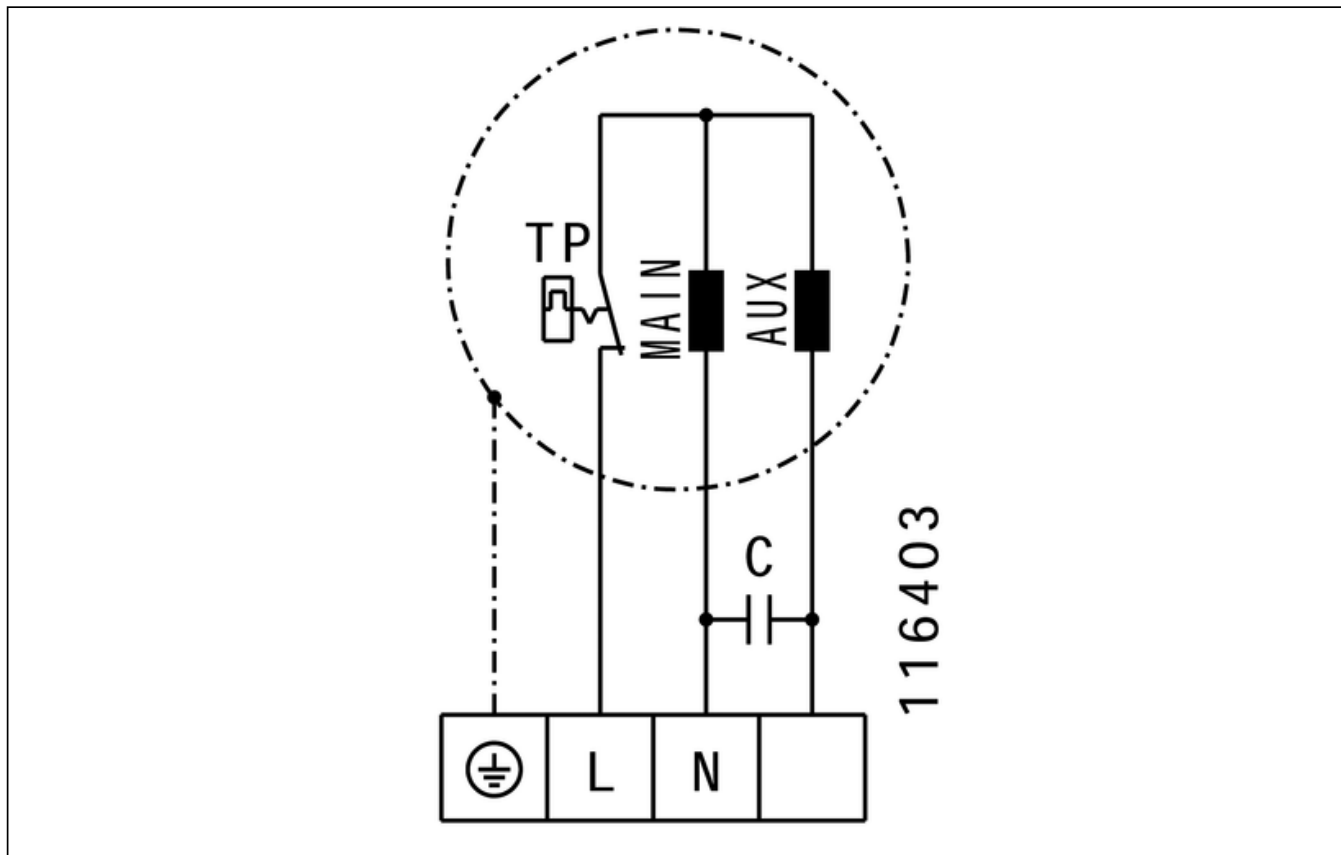

KVR 3015 E2 40

135000

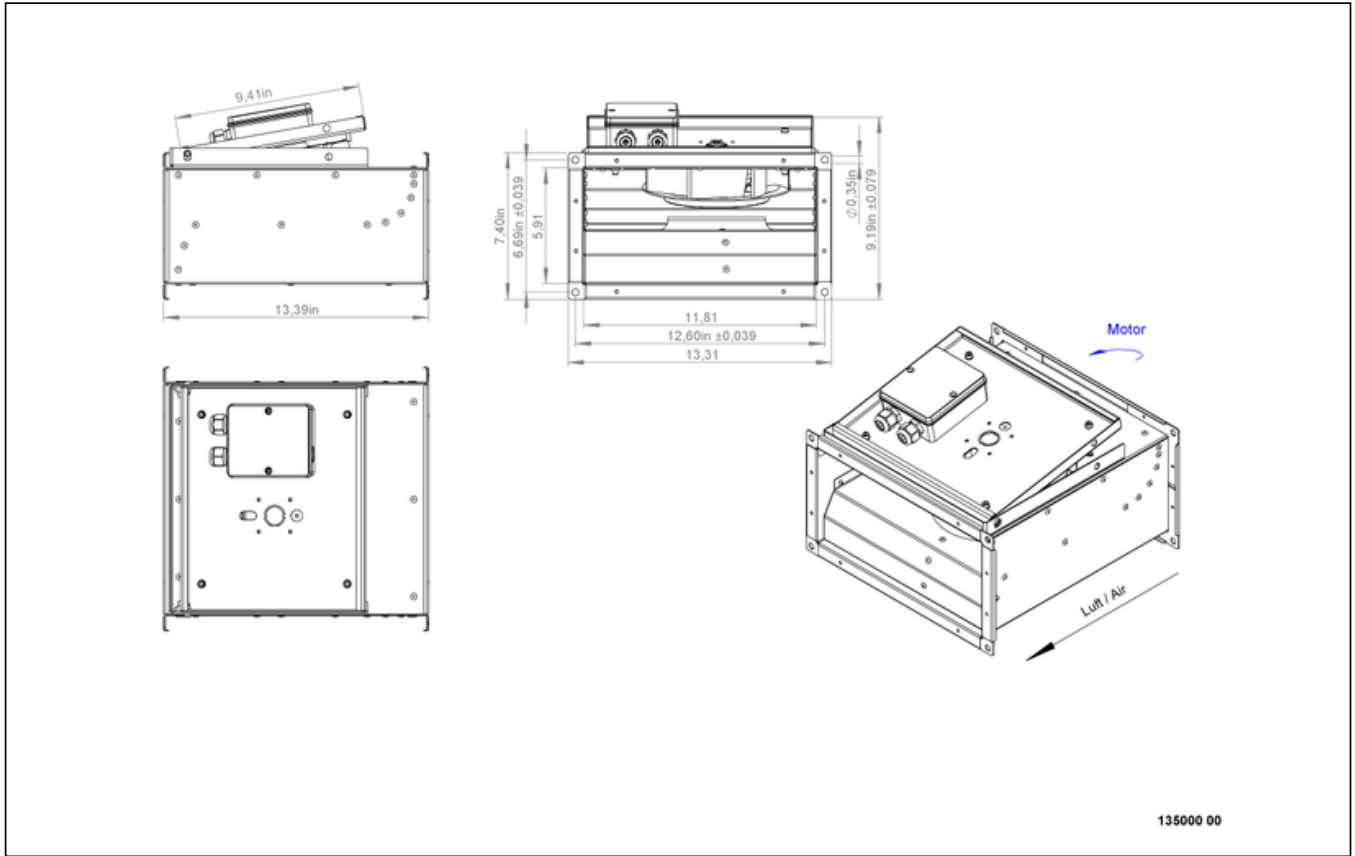

to the product detail page

KVR 3015 E2 40

135000

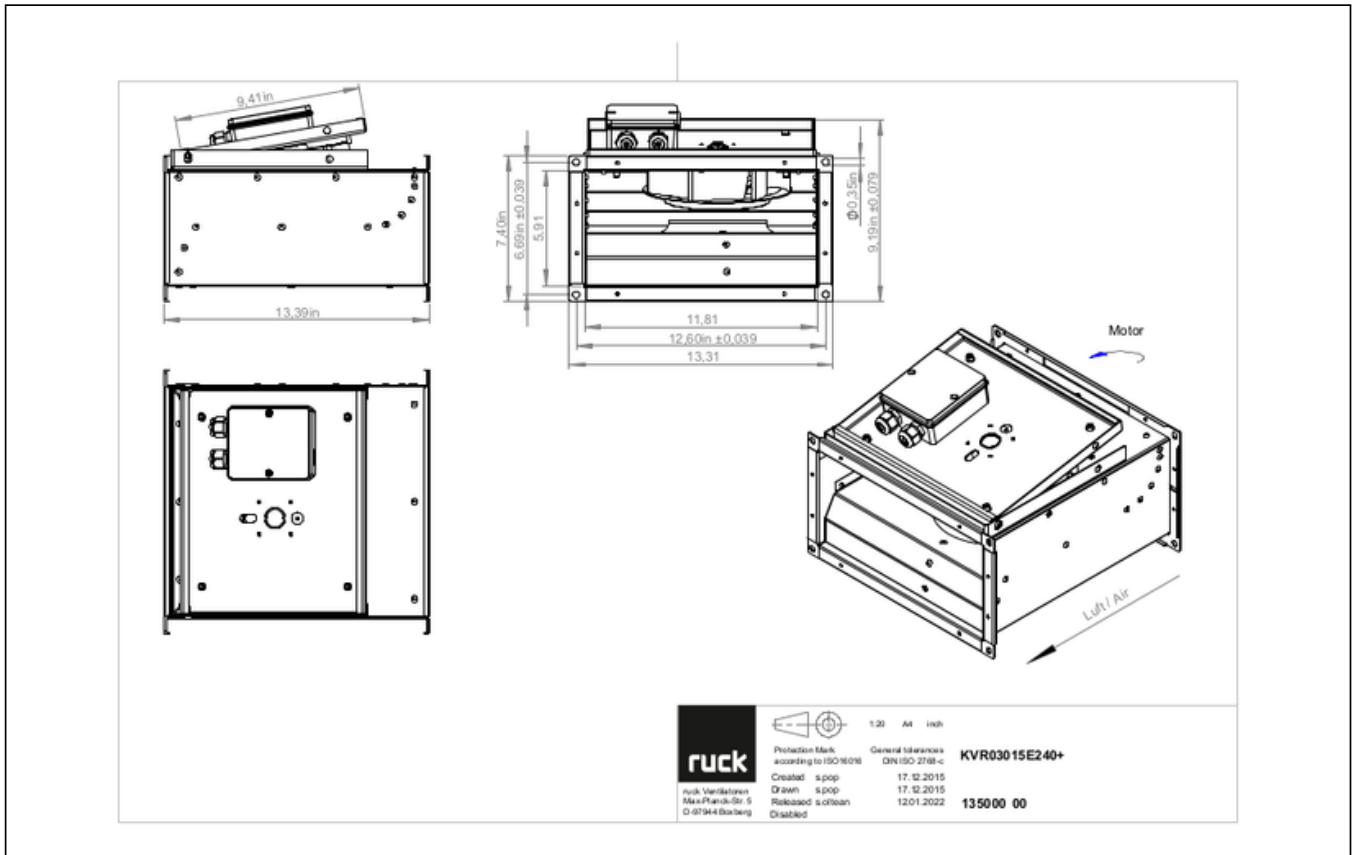

MECHANICAL ACCESSORIES

VS 3015 | 102801



- Duct connector, flexible
- Standard profile flange P20
- Galvanized steel sheet, plastic band (PVC)
- Temperature resistant up to 70 °C

VKK 3015 | 103897



- Automatic shutter
- Plastic, weather resistant
- Temperature resistant up to 70 °C



to the product detail page

KVR 3015 E2 40

135000

ELECTRICAL ACCESSORIES

GS 01 | 102787



- Isolator switch
- $U_{max} = 400\text{ V}$, 50/60 Hz
- Switching capacity 400 V 3~ = 5,5 kW
- $I_{max} = 16\text{ A}$

MTY 1 | 103428



- Electronic controller
- Stepless
- 230 V ~, 50 Hz
- Max. ambient temperature 35 °C
- $I_{max} = 1\text{ A}$
- Surface and flush mounting

TES 0145 | 111858



- Step transformer
- 230 V ~, 50/60 Hz

TEE 015 | 115893



- 5-step transformer
- 230 V ~, 50/60 Hz



to the product detail page