

### Flange connection plate

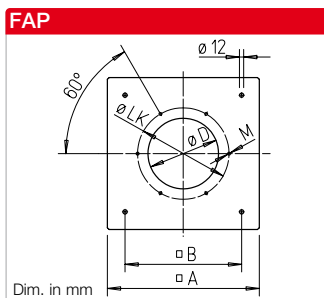

### Flange connection plate FAP

Made of galvanised steel sheet. This allows the connection of the duct system and accessories to the roof fans DV EC if no base silencer SSD is used.

Type	FAP 200	FAP 250	FAP 400
Ref. no.	08382	08383	08384
□ A mm	430	550	635
□ B mm	330	450	535
∅ D mm	200	250	400
∅ LK mm	259	286	438
M	M 6	M 6	M 8
Gewicht kg	1.8	3.0	3.3

### Flange, flanged flex. connector



#### Compatible with roof fan:

DV EC 200		DV EC 250		DV EC 400	
Type	Ref. no.	Type	Ref. no.	Type	Ref. no.
<b>Flange connection plate</b> – Required for duct-pipe connection					
<b>FAP 200</b>	08382	<b>FAP 250</b>	08383	<b>FAP 400</b>	08384
<b>Counterflange</b>					
<b>DFR 200</b>	01201	<b>FR 250</b>	01203	<b>FR 400</b>	01206
<b>Flanged flexible connector</b>					
<b>DSTS 200</b>	01218	<b>STS 250</b>	01220	<b>STS 400</b>	01223

See product pages for detailed description.

### Flat roof base

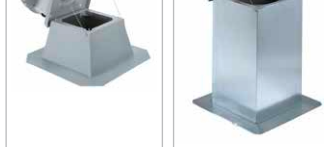

#### Compatible with roof fan:

DV EC 200		DV EC 250		DV EC 400	
Type	Ref. no.	Type	Ref. no.	Type	Ref. no.
<b>Flat roof base</b> – With swing-action device for easy inspection					
<b>FDS 200</b>	01378	<b>FDS 250</b>	01379	<b>FDS 400</b>	01380
<b>Base silencer</b> – With swing-action device for easy inspection					
<b>SSD 200</b>	05290	<b>SSD 250</b>	05292	<b>SSD 400</b>	05291

See product pages for detailed description.

### Base silencer

### Fire protection

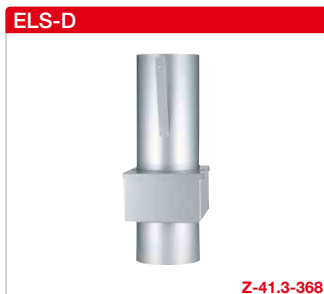

### Fire protection ceiling seal ELS-D to prevent spread of fire to other floors.

Installation in main ventilation pipe according to DIN 18017 K90. Maintenance-free. For ventilation or mixed (even with combustible pipes) installation shafts which only require cladding with 12.5 mm

plasterboard. All other parts (disc valves etc.) without fire resistance classification. Branch and connection pipes also available in Aluflex pipe. Shutter elements KAK are available to prevent the backflow of cold smoke (see left page or page 597).

ND mm main pipe	100	125	140	160	180	200
Type	ELS-D 100	ELS-D 125	ELS-D 140	ELS-D 160	ELS-D 180	ELS-D 200
Ref. no.	00270	00185	00186	00187	00188	00271

### Control system

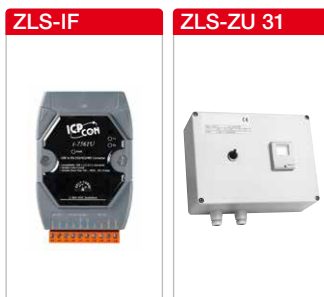

### Interface

Interface for commissioning or controlling the fan in combination with a PC/laptop. Incl. mains adapter, adapter cable and software.

**ZLS-IF** Ref. no. 08391

### Electronic timer module with day and night switchover

Allows the parallel operation of max. 31 DV EC roof fans. The rocker switch is used to enable the DV EC fans. The day and night switchover takes place via the settings in the display.

Incl. main switch. 230 V, 50 Hz.  
**ZLS-ZU 31** Ref. no. 08388

### Universal control system

For the continuously variable control or regulation of single and three-phase EC fans with a setpoint of 0–10 V DC:

**EUR EC** Ref. no. 01347

### Speed potentiometer

For the direct control/setpoint setting of EC fans with a potentiometer input.

**PU 10 (UP)** Ref. no. 01734

**PA 10 (AP)** Ref. no. 01735

Accessory details	Page
Roof install. accessories	559 f.
Ventilation grilles	561 ff.
Extract air elements	574 ff.
Intake air elements	586 ff.
Fire protection systems	590 ff.
– Ceiling seal	596 ff.
Universal control systems, electronic controllers, speed potentiometer	613 ff.