



Fast Trak[®] Range

For the installation of electrical containment, pipework, ductwork and other mechanical services



- Versatile
- Quick installation
- Safe & secure

Fast Trak - Standard

Page 4

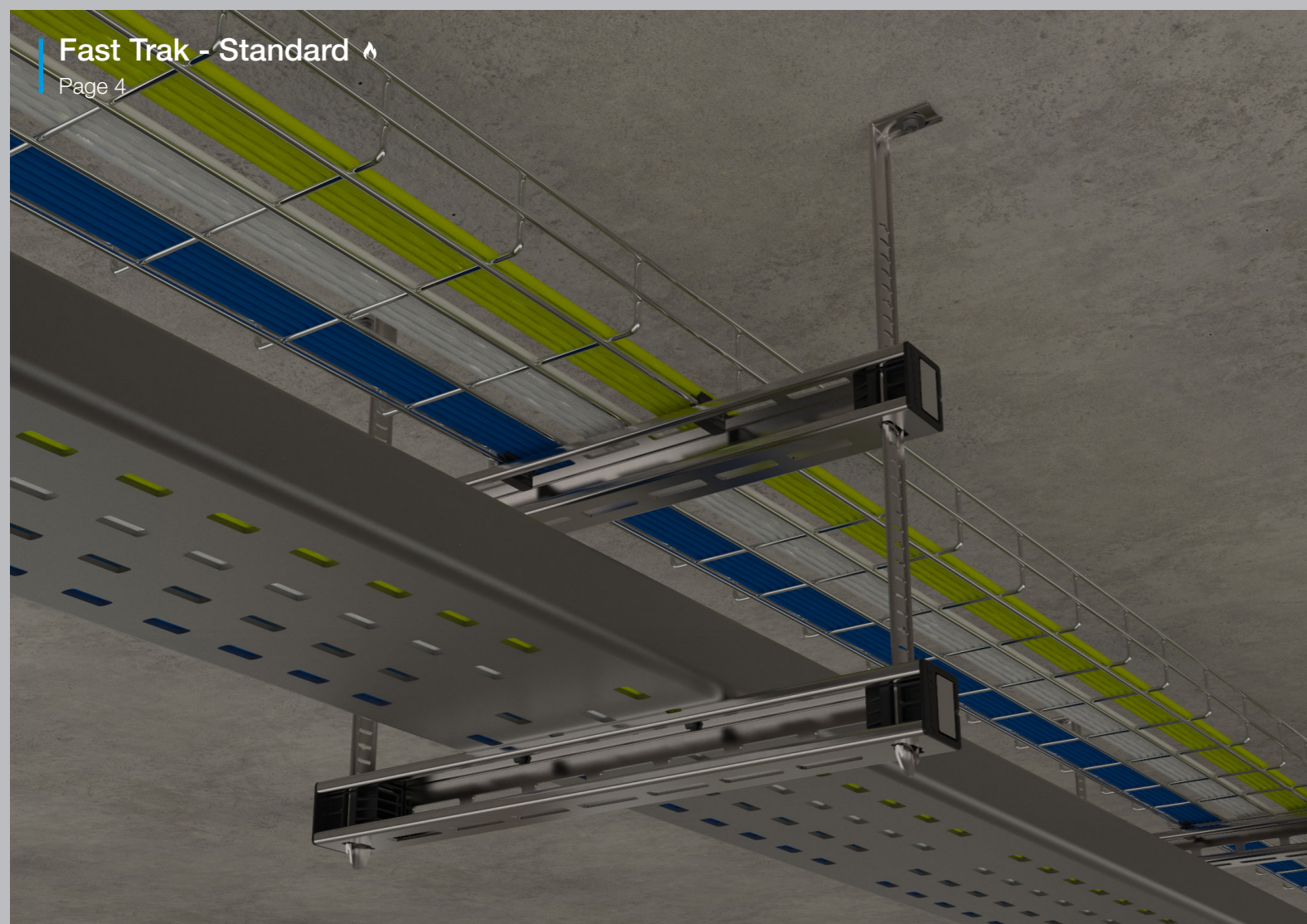

CB Clip

Page 10

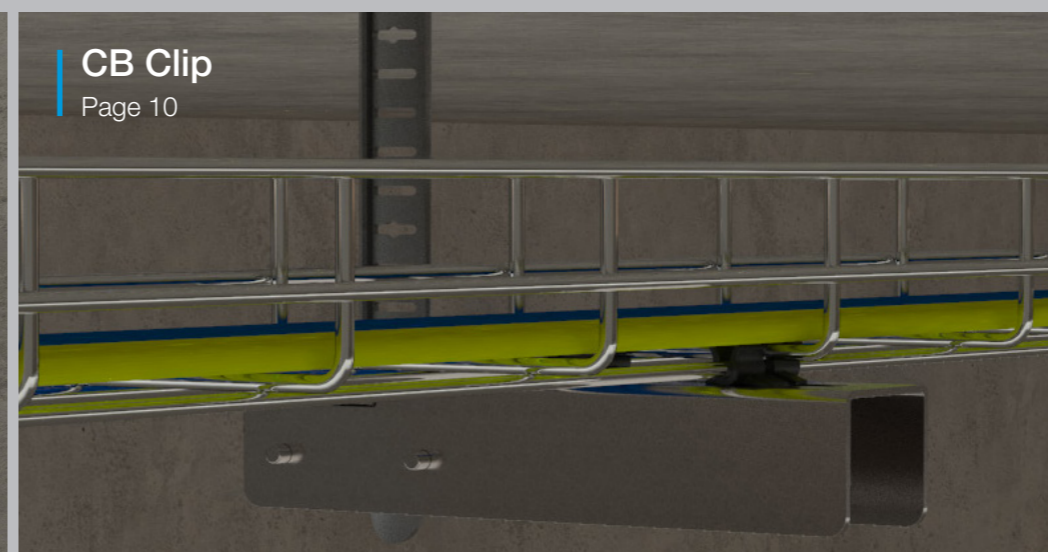

CT Clip

Page 10

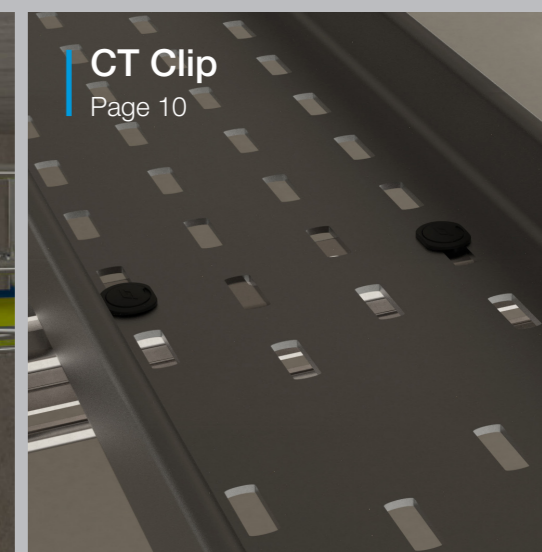

Trunking Clamp

Page 10

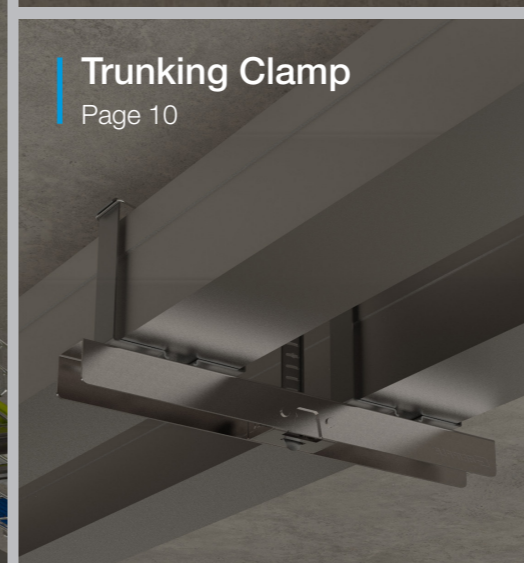

Conduit Clamp

Page 10

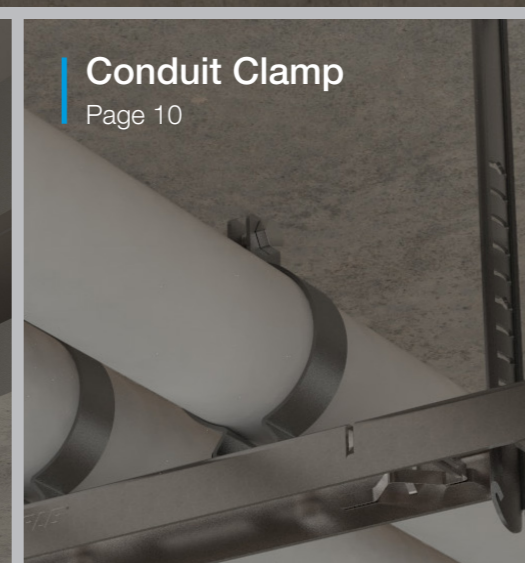

Fast Trak - Low Profile

Page 5



Fast Trak - Side Loading

Page 6

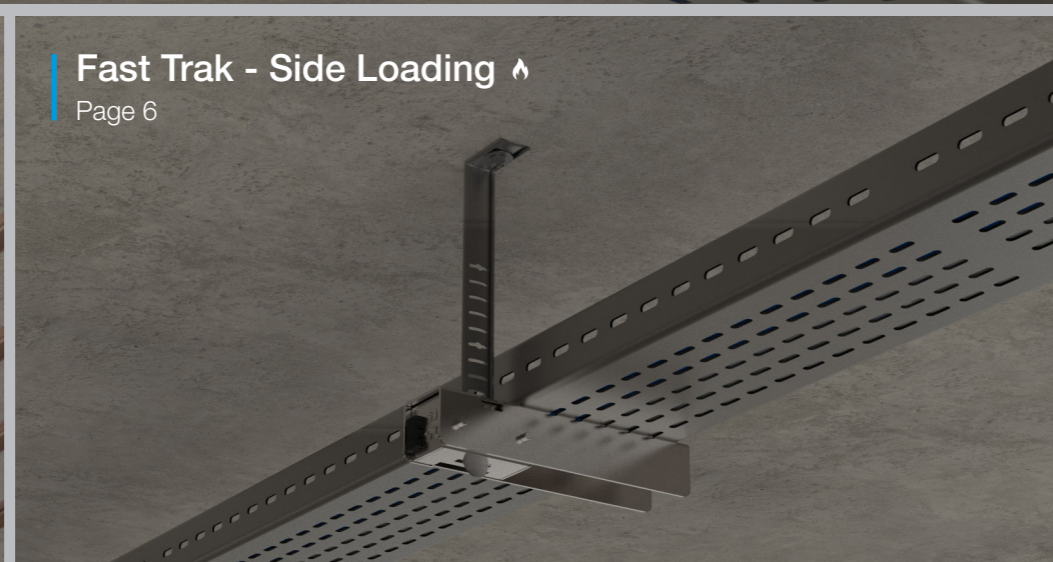

J-Hook

Page 10

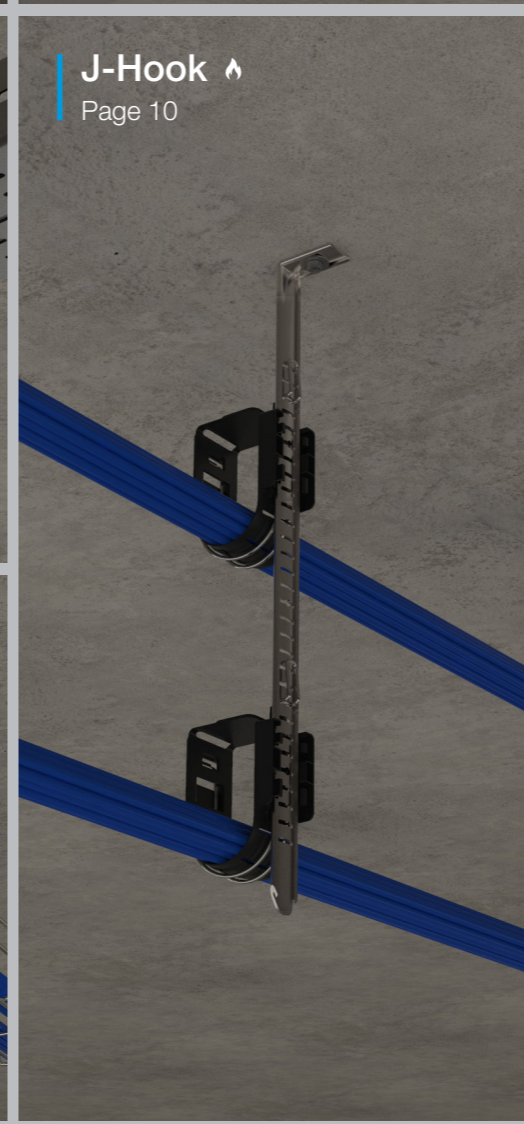

Bracket Cover

Page 10



Fast Trak - Segregated

Page 7



Fire Fastener

Page 11



Vibration Dampener

Page 11

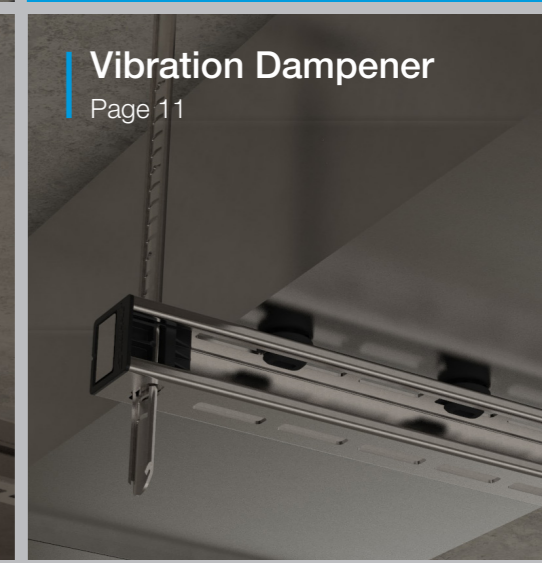

Gripple Fast Trak® is a rapid bracket suspension solution for mechanical and electrical services. Removing labour intensive on-site activity associated with traditional suspension systems, Fast Trak is a pre-fabricated, off-site solution which vastly simplifies the installation of cable containment, pipework and ductwork in building services applications.

The next instalment in Gripple innovation, Fast Trak delivers significant cost and labour savings, carbon efficiencies and minimises health and safety concerns.

Products shown are for internal use only. Images shown for illustrative purposes only. Please refer to product installation instructions for full information.

Fast Trak® - Standard



Pre-fabricated trapeze bracket solution offering speed, flexibility and efficient use of space, for the installation of electrical containment, pipework, ductwork and other mechanical services in restricted places.

Fire Rated – tested to F120 in accordance with BS EN 1363-1:2012 temperature curve*

Quick – up to six times faster to install than traditional suspension systems

Safe – pre-fabricated system which removes the need to cut threaded rod or channel on-site

Tool free adjustment – bracket can be moved up and down the tracks to accommodate changes in position during installation

Zero waste – tracks bend neatly under bracket

Versatile – four-sided bracket provides suspension point on every face

Easy measurement – indicators for marking fixing points on the ceiling; M4 level markers on the tracks highlight 50 mm increments, no leveling tools required

Neat & tidy – system can be 'stacked' on-site to reduce storage requirements

Space saver – can be multi-tiered to accommodate additional services



Available Bracket Sizes

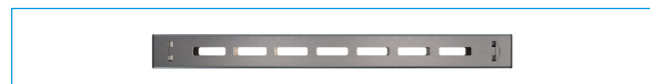

System Rating Up to 200 kg' SWL (3:1) **Bracket Sizes** 170 mm - 1470 mm Bracket sizes increase in 100 mm increments

Available Track Sizes



Track Sizes 200 mm - 1500 mm Track sizes increase in 100 mm increments

Installation Steps

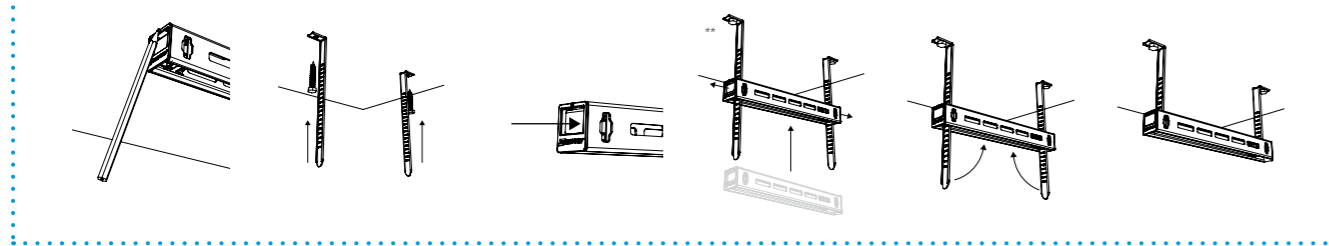

*Fire Fastener needed when used channel-side up ('u' orientation). **When installed correctly, button must be fully retracted and flush with the cartridge edge. Do not adjust under load. Contact Gripple for full product information, submittal data and technical support. †Tested at ambient temperatures, see bracket data on page 12 for maximum working load. Excess tracks can also be snapped off once bracket is levelled & secured for a neater finish. Bending tracks by hand is not recommended when excess is under 100 mm.

Fast Trak® - Low Profile



A space efficient low profile pre-fabricated trapeze bracket. Ideal for use with electrical containment, pipework and mechanical services in ultra-restricted ceiling spaces.

Fire Rated – tested to F120 in accordance with BS EN 1363-1:2012 temperature curve

Space saver – 21 mm bracket depth is even lower profile than standard Fast Trak range

Quick – up to six times faster to install than traditional suspension systems

Safe – pre-fabricated system which removes the need to cut threaded rod or channel on-site

Tool free – bracket can be moved up and down the tracks to accommodate changes in position during installation

Easy measurement – indicators at each end of the bracket can be used as a measurement guide when marking fix points in the ceiling

Neat & tidy – system can be 'stacked' on-site to reduce storage requirements

Aesthetic – tracks bend neatly under bracket



Available Bracket Sizes



System Rating Up to 75 kg' SWL (3:1) **Bracket Sizes** 190 mm - 1490 mm Bracket sizes increase in 100 mm increments

Available Track Sizes



Track Sizes 200 mm - 1500 mm Track sizes increase in 100 mm increments

Installation Steps

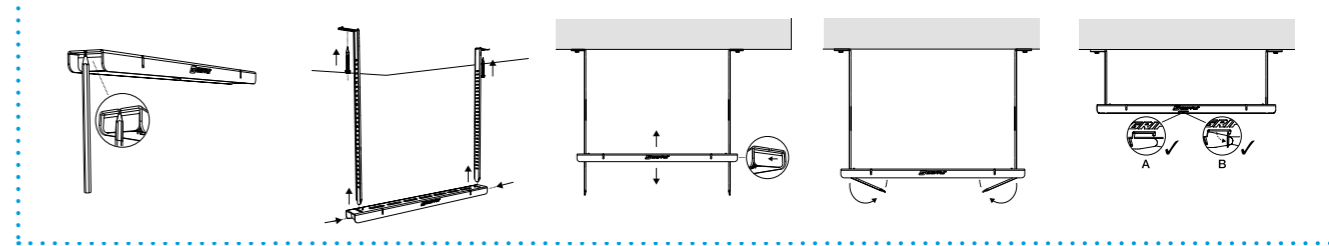

Do not adjust under load. Contact Gripple for full product information, submittal data and technical support. †Tested at ambient temperatures, see bracket data on page 12 for maximum working load. Excess tracks can also be snapped off once bracket is levelled & secured for a neater finish. Bending tracks by hand is not recommended when excess is under 100 mm.

Fast Trak® - Side Loading



Pre-fabricated side loading bracket solution offering speed and flexibility for the installation of lightweight electrical containment, pipework, ductwork and other mechanical services in restricted places.

Fire Rated – tested to F120 in accordance with BS EN 1363-1:2012 temperature curve

Quick – up to six times faster to install than traditional suspension systems

Safe – pre-fabricated system which removes the need to cut threaded rod or channel on-site

Tool free – bracket can be moved up and down the tracks to accommodate changes in position during installation

Secure – safety locks ensure security once brackets and tracks are in place



Space saver – can be multi-tiered to accommodate additional services

Easy installation – lightweight services can be side loaded onto the bracket

Neat & tidy – system can be 'stacked' on-site to reduce storage requirements



Available Bracket Sizes

	
Single Load ¹ FTBS-180 – 15 kg 3:1 SWL	Twin Load ¹ FTBT-200 – 30 kg 3:1 SWL FTBT-300 – 30 kg 3:1 SWL FTBT-400 – 30 kg 3:1 SWL

Available Track Sizes

Track Sizes 200 mm - 600 mm
Track sizes increase in 100 mm increments

Installation Steps

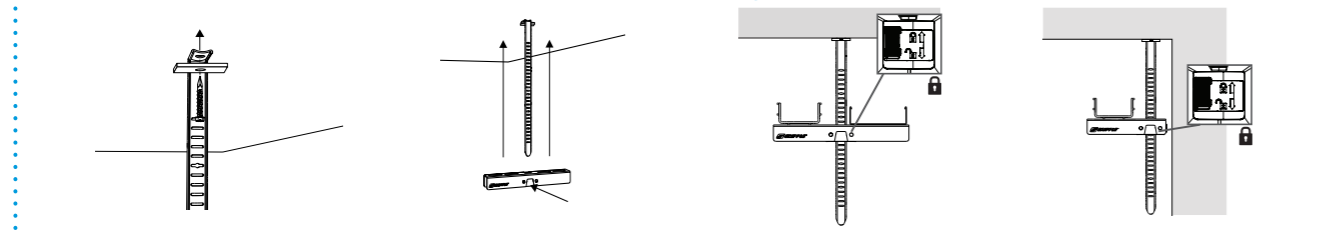

Do not adjust under load. ¹Tested at ambient temperatures, contact Gripple for full product information, submittal data and technical support. Excess tracks can also be snapped off once bracket is levelled & secured for a neater finish. Bending tracks by hand is not recommended when excess is under 100 mm.

Fast Trak® - Segregated



Pre-fabricated side loading bracket solution offering speed and flexibility for the installation of lightweight services that require separation such as data and power cables.

Fire Rated – tested to F120 in accordance with BS EN 1363-1:2012 temperature curve

Quick – up to six times faster to install than traditional suspension systems, lightweight services can be side loaded onto the bracket

Safe – pre-fabricated system which removes the need to cut threaded rod or channel on-site

Compliant – adheres to regulations where electrical and power must be separated by a required distance

Tool free adjustment – bracket can be moved up and down the tracks to accommodate changes in position during installation

Secure – safety locks ensure security once brackets & tracks are in place

Space saver – can be multi-tiered to accommodate additional services

Easy measurement – indicators above adjustment buttons on the bracket offer a measurement guide when marking fixing points on the ceiling; M4 level markers on the tracks highlight 50 mm increments, with no leveling tools required

Neat & tidy – system can be 'stacked' on-site to reduce storage requirements



Available Bracket Sizes

Bracket ¹ FTBSG-130 – 2 x 22.5 kg 3:1 SWL FTBSG-240 – 2 x 22.5 kg 3:1 SWL FTBSG-350 – 2 x 22.5 kg 3:1 SWL

Available Track Sizes

Track Sizes 200 mm - 600 mm
Track sizes increase in 100 mm increments

Installation Steps

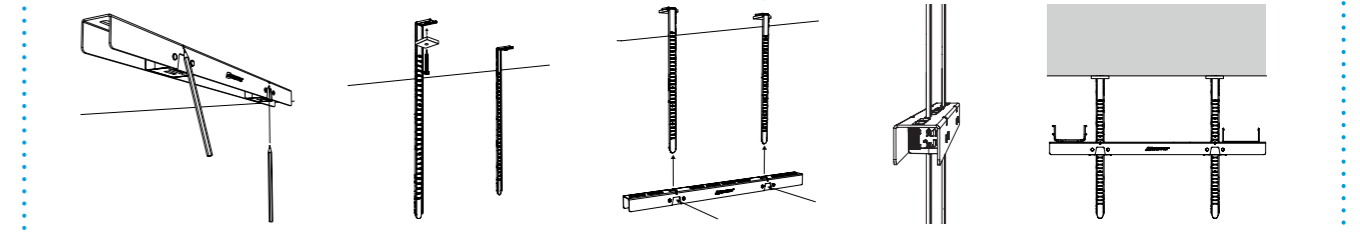

Do not adjust under load. ¹Tested at ambient temperatures, contact Gripple for full product information, submittal data and technical support. Excess tracks can also be snapped off once bracket is levelled & secured for a neater finish. Bending tracks by hand is not recommended when excess is under 100 mm.

Fire Fastener

A fire rated push-fit fastener designed for attaching onto a Fast Trak bracket. The fastener is only required when a bracket is in a 'u' orientation (i.e. channel side up).

Fire Rated – tested to F120 in accordance with BS EN 1363-1:2012 temperature curve

Quick – no tool installation

Simple – push fit-design

Ready-to-use – pre-assembled fastener

Compatible – facilitates the use of the Fast Trak system in fire rated applications

Versatile – fits all bracket lengths of Fast Trak - Standard

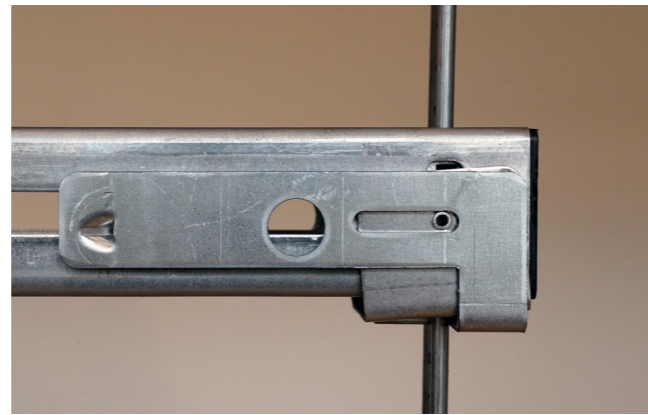

Installation Steps

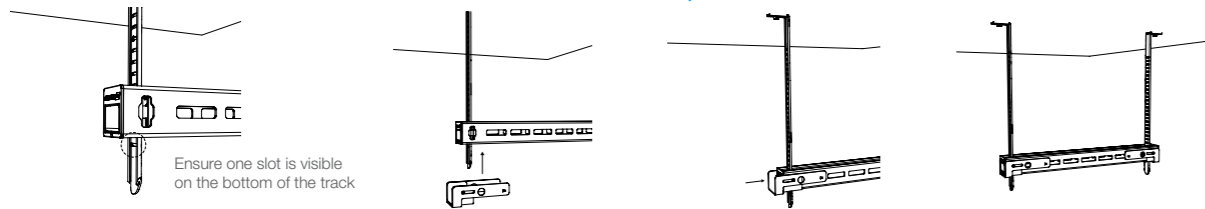

Do not adjust under load. Contact Gripple for full product information, submittal data and technical support. Excess tracks can also be snapped off once bracket is levelled & secured for a neater finish. Bending tracks by hand is not recommended when excess is under 100 mm.

Mounting Methods



Concrete Screw

Suitable for cracked and non-cracked concrete. Can be removed.



Shot Fire X-U P8

High-performance single nail with steel washer for concrete and steel, for powder-actuated tools.



Drop-In Anchor & M10 Screw

Suitable for cracked and non-cracked concrete, precast hollow core concrete and hard natural stone.

Fast Trak Product Codes

1 CHOOSE YOUR FAST TRAK BRACKET LENGTH*										
Standard			Low Profile			Side Loading				
239 mm FTB-170	339 mm FTB-270	439 mm FTB-370	235 mm FTBL-190	335 mm FTBL-290	435 mm FTBL-390	180 mm FTBS-180	210 mm FTBT-200	290 mm FTBT-300		
539 mm FTB-470	639 mm FTB-570	739 mm FTB-670	535 mm FTBL-490	635 mm FTBL-590	735 mm FTBL-690	400 mm FTBT-400				
839 mm FTB-770	939 mm FTB-870	1039 mm FTB-970	835 mm FTBL-790	935 mm FTBL-890	1035 mm FTBL-990					
1139 mm FTB-1070	1239 mm FTB-1170	1339 mm FTB-1270	1135 mm FTBL-1090	1235 mm FTBL-1190	1335 mm FTBL-1290					
1439 mm FTB-1370	1539 mm FTB-1470		1435 mm FTBL-1390	1535 mm FTBL-1490						
						Segregated				
						607 mm FTBSG-130	827 mm FTBSG-240	1047 mm FTBSG-350		

*Part codes shown above relate to the suspension space for positioning building services onto the Fast Trak brackets, not the full length of the brackets. For more information on bracket sizes and safe working loads please contact Gripple Technical Services.

2 CHOOSE YOUR FAST TRAK TRACK LENGTH									
Suspension Track									
200 mm FTT-200	300 mm FTT-300	400 mm FTT-400	500 mm FTT-500	600 mm FTT-600	700 mm FTT-700	800 mm FTT-800			
900 mm FTT-900	1000 mm FTT-1000	1100 mm FTT-1100	1200 mm FTT-1200	1300 mm FTT-1300	1400 mm FTT-1400	1500 mm FTT-1500			

Accessories

CB Clip

Developed for the quick fastening of cable basket to Gripple Fast Trak. Available in two different sizes.



CT Clip

Developed for the quick fastening of cable tray to Gripple Fast Trak. Available in two different sizes.



Bracket Cover

Neatly hides tracks to further enhance the aesthetics of the Fast Trak system.

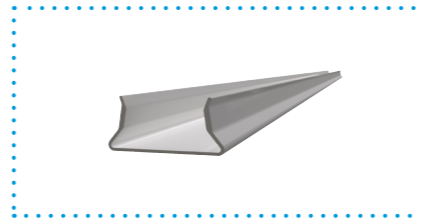

Trunking Clamp

Quarter turn attachment to Fast Trak bracket for quick installation of trunking. Available in four different sizes.



Conduit Clamp

Quarter turn attachment to Fast Trak brackets for quick installation of conduit. Available in eight different sizes.



J-Hook 🔥

For use in conjunction with Fast Trak tracks to support all types of data cables.



Seismic Brace Adaptor

Used in conjunction with seismic bracing kits to allow the Fast Trak system to be installed in areas of seismic activity or where blast protection is necessary.



Vibration Dampener

The Vibration Dampener Pad (VDP) is designed for vibration reduction when installing rectangular ducting on Fast Trak.



Fire Fastener 🔥

A fire rated push-fit fastener designed for attaching onto a Fast Trak bracket. The fastener is only required when a bracket is in a 'u' orientation (i.e. channel side up).

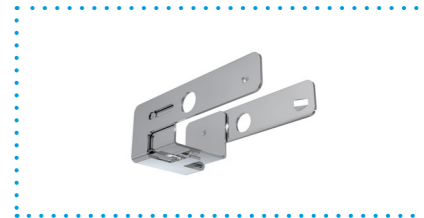

Track Protector

An end cap designed for protruding tracks to reduce the risk of injury. Available in two different sizes.



QT Universal Clamp

Designed for use with Gripple Brackets to provide quick and easy pipework installation.



QT Compact Clamp

Used in conjunction with Gripple Brackets for quick and easy support of all types of pipework within mechanical and plumbing services.

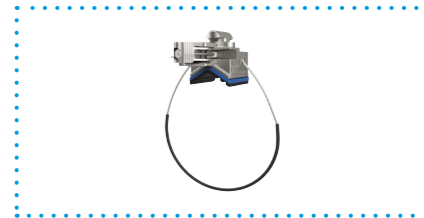

Fast Trak Bracket Data

Maximum Working Load*

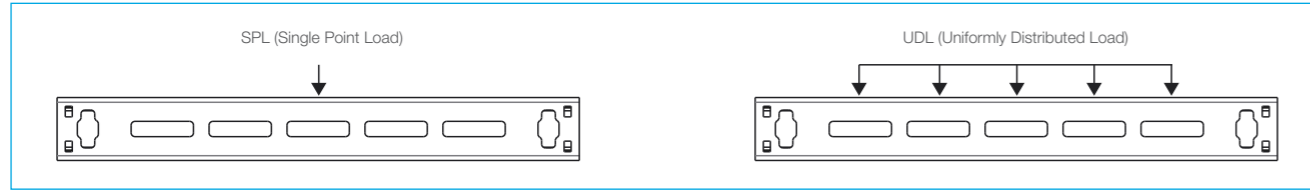

Fast Trak - Standard (kg/kN)

FTB-270 to FTB-1370

Bracket Orientation**	'n' orientation		'c' orientation	
	kg	kN	kg	kN
Single Point Load (SPL) @ 3:1	100 kg	0.98 kN	70 kg	0.68 kN
Uniformly Distributed Load (UDL) @ 3:1	200 kg	1.96 kN	130 kg	1.27 kN

FTB-1470

Single Point Load (SPL) @ 3:1	100 kg	0.98 kN	70 kg	0.68 kN
Uniformly Distributed Load (UDL) @ 3:1	175 kg	1.71 kN	130 kg	1.27 kN

Fast Trak - Low Profile (kg)

Bracket	FTBL 190	FTBL 290	FTBL 390	FTBL 490	FTBL 590	FTBL 690	FTBL 990	FTBL 890	FTBL 990	FTBL 1090	FTBL 1190	FTBL 1290	FTBL 1390	FTBL 1490
UDL (Uniformly Distributed Load)	230	160	130	110	100	90	70	70	55	55	50	40	40	35
SPL (Single Point Load)	175	115	75	70	60	50	40	40	30	30	25	20	20	20

Fast Trak - Low Profile (kN)

Bracket	FTBL 190	FTBL 290	FTBL 390	FTBL 490	FTBL 590	FTBL 690	FTBL 990	FTBL 890	FTBL 990	FTBL 1090	FTBL 1190	FTBL 1290	FTBL 1390	FTBL 1490
UDL (Uniformly Distributed Load)	2.26	1.57	1.27	1.08	0.98	0.88	0.69	0.69	0.54	0.54	0.49	0.39	0.39	0.34
SPL (Single Point Load)	1.72	1.13	0.74	0.69	0.59	0.49	0.39	0.39	0.29	0.29	0.25	0.20	0.20	0.20

*For more details on specified loads or additional deflection ratings please contact Gripple Technical Services. When loading multiple faces the total load applied must not exceed the values stated.

**Can also be installed in a 'u' orientation but a Fire Fastener must be used to retain fire rating. Contact Gripple Technical Services for more information on this application.

Key Recommendations

Failure to comply with these recommendations may result in product malfunction and possible damage to property or person and will invalidate the Gripple guarantee. Gripple products are guaranteed to be free from defects in materials and workmanship in accordance with our terms and conditions. No other warranty, whether express or implied, including any warranty of merchantability or fitness for purpose shall exist in connection with the sale or use of any Gripple product.

Full technical information and installation instructions should be obtained directly from Gripple Limited, Gripple Europe, Gripple Inc., Gripple Japan, Gripple Poland, Gripple India, Gripple Germany, any regional Gripple office, or via the website (www.gripple.com). These Key Recommendations may be amended from time to time; please view the Key Recommendations page on the Gripple website (www.gripple.com) for the most up-to-date information.

Please adhere to the following usage recommendations:

- Loads**
 Always operate the product within its stated safe working load range. Suspend static loads only. Do not subject to shock loading. Do not adjust under load.
- Hanging at an angle to vertical**
 Ensure that the load calculation considers the effect of 'side load'. For example, at an angle of 60° to vertical the SWL is effectively reduced by 50%.
- Ducting:** When installing included angle teardrop hangers on round/spiral ducting or pipes, the final included angle of the assembly should not exceed 60°.
- Y-Fit:** Legs on Y-Fit not to be installed greater than 60°.
- Environment**
 Do not use in chlorinated or chemically corrosive atmospheres. Standard hangers are for use in dry and air conditioned environments only. Stainless steel hangers should be considered for high to saturated humid environments after validation by a competent person.
- Not suitable for swimming pools.
- Joining**
 Never join two ends together in-line.
- Traceability**
 Always use the Gripple hanger with the specified wire rope supplied by Gripple. Gripple products should only be used with products supplied by Gripple Ltd., and the warranty will not apply if our products are used with any products supplied by third parties.
- Lifting**
 Do not use for lifting, either by crane or as part of a pulley system.
- Impact**
 If there is potential for impact on the wire rope suspension or suspended services, seek advice from Gripple Ltd. Technical Services prior to installation.
- Lubrication**
 Do not apply oil or any other lubricant to the hanger or any other part of the assembly.
- Wire Rope**
 Trim any damaged filaments with the wire cutter before use.
- Installation**
 Do not walk or stand on the Gripple product installation. Gripple products must not be used for personal suspension, fall protection or harnessing people.
- Painting**
 Do not paint the hanger prior to installation. Ensure the hanger is in its final position prior to applying any paint to the wire rope assembly. Do not move the fastener after painting.
- Storing**
 Do not store the product outdoors, or in damp or abnormal conditions.
- Repair, Modification and Re-use**
 Do not repair, modify or re-use Gripple products. If you have any queries regarding product performance, please contact technical.services@gripple.com

Quality & Approvals

Gripple UK is ISO 9001:2015 and ISO 14001 certified. Gripple products meet the highest standards of quality with lowest environmental impact.

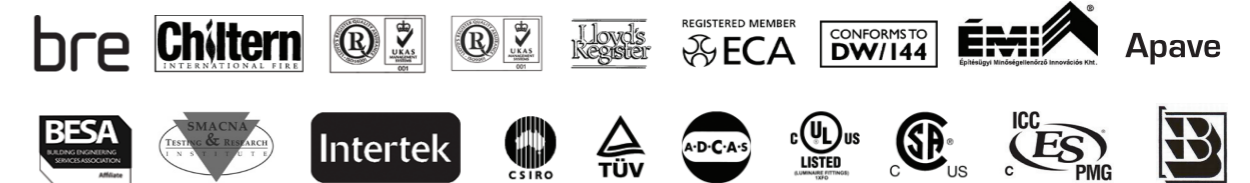

Gripple's policy is one of continuous development and innovation. We therefore reserve the right to alter specifications, etc. without notice.

Fire Rated Product Matrix

All figures shown below are absolute loads. For safety factors of ambient temperature loads, please contact Gripple Technical Services for more information.

Temperature	3rd Party Fire Tested to BS 476 (ISO 834) Fire Curve Temperatures			
	842°C	945°C	1006°C	1049°C
Test Duration	30 mins (FR30)	60 mins (FR60)	90 mins (FR90)	120 mins (FR120)
Fast Trak - Standard				
Top 'n' Orientation (All sizes)	85 kg	65 kg	55 kg	48 kg
Bottom 'u' Orientation** (All sizes)	60 kg	60 kg	60 kg	44 kg
Side 'c' Orientation (All sizes)	80 kg	60 kg	54 kg	41 kg
Fast Trak - Low Profile				
Low Profile (All sizes)	80 kg	75 kg	60 kg	48 kg
Fast Trak - Side Loading (Single Load)				
Central 180	15 kg	15 kg	15 kg	15 kg
Central 210	15 kg	15 kg	15 kg	15 kg
Central 290	15 kg	15 kg	15 kg	15 kg
Central 400	15 kg	15 kg	15 kg	15 kg
Fast Trak - Side Loading (Twin Load)				
Central 210	15 kg (7.5 kg per side)	15 kg (7.5 kg per side)	15 kg (7.5 kg per side)	10 kg (5 kg per side)
Central 290	15 kg (7.5 kg per side)	15 kg (7.5 kg per side)	15 kg (7.5 kg per side)	10 kg (5 kg per side)
Central 400	15 kg (7.5 kg per side)	15 kg (7.5 kg per side)	15 kg (7.5 kg per side)	10 kg (5 kg per side)
Fast Trak - Segregated				
Segregated (All sizes)	40 kg	40 kg	20 kg	10 kg
Universal Bracket				
Top 'n' Orientation (All sizes)	85 kg	65 kg	55 kg	48 kg
Side Orientation (All sizes)	80 kg	60 kg	54 kg	41 kg
Low Profile Bracket				
Low Profile (All sizes)	90 kg	45 kg	45 kg	45 kg
Accessories				
J-Hook	1.25 kg	1.25 kg	1.25 kg	1.25 kg

Fire Rated Product Matrix

Temperature	3rd Party Fire Tested to BS 476 (ISO 834) Fire Curve Temperatures			
	842°C	945°C	1006°C	1049°C
Test Duration	30 mins (FR30)	60 mins (FR60)	90 mins (FR90)	120 mins (FR120)
Gripple Fire Rated Hangers				
HF2...SS-F	15 kg	7.5 kg	2.5 kg	2.5 kg
HF3...SS-F	45 kg	20 kg	10 kg	10 kg
Gripple FR Y-Fit Accessories				
AY2-HG...SS-F - Snap Hook End Fixing	15 kg	5 kg*	2.5 kg	2.5 kg
AY3-HG...SS-F - Snap Hook End Fixing	45 kg	20 kg	10 kg	7.5 kg*
AY2-KS...SS-F - Karabiner (8-80S) End Fixings	15 kg	7.5 kg	2.5 kg	-
AY3-KS...SS-F - Karabiner (8-80S) End Fixings	25 kg	20 kg	10 kg	-
Gripple Trapeze Plus FR Hangers				
MTZ2...SS-F	15 kg	7.5 kg	2.5 kg	2.5 kg
MTZ3...SS-F	45 kg	20 kg	10 kg	10 kg
MTZ4...F	100 kg	50 kg	25 kg	25 kg
Gripple Trapeze Plus FR Hangers with Cable Basket Adaptor				
MTZ2...SS-CBA-F	15 kg	7.5 kg	2.5 kg	2.5 kg
Gripple Trapeze Plus FR Hangers - Side Exit				
MTS2...SS-F	15 kg	7.5 kg	2.5 kg	2.5 kg
MTS3...SS-F	45 kg	20 kg	10 kg	10 kg
Gripple G-Brackets				
G100	30 kg	30 kg	15 kg	-
G200	30 kg	30 kg	15 kg	-
G300	30 kg	15 kg	15 kg	-
G400	30 kg	15 kg	15 kg	-
Fire Rated Clip				
FRC-S-100-P-SS-F (Fire Rated Clip - Single)	0.24 kg	-	-	-
FRC-D-100-P-SS-F (Fire Rated Clip - Double)	2 x 0.24 kg	-	-	-

	Loop	M8 Stud	M8 Channel Nut	M10 Stud	Eyelet	90° Eyelet	Toggle	DX Shot Fire †
Gripple Fire Rated Hangers								
HF2...SS-F	∅	∅	∅	-	∅	∅	-	∅
HF3...SS-F	∅	∅	∅	-	∅	o	∅	-
Gripple Trapeze Plus FR Hangers								
MTZ2...SS-F	∅	∅	∅	-	∅	∅	∅	∅
MTZ3...SS-F	∅	∅	∅	-	∅	o	∅	-
MTZ4...F	-	-	-	∅	-	-	-	-
Gripple Trapeze Plus FR Hangers with Cable Basket Adaptor								
MTZ2...SS-CBA-F	∅	∅	∅	-	∅	∅	∅	∅
Gripple Trapeze Plus FR Hangers - Side Exit								
MTS2...SS-F	∅	∅	∅	-	∅	∅	∅	∅
MTS3...SS-F	∅	∅	∅	-	∅	o	∅	-

Notes

British Standards Institution, BS 476-20:1987, Fire tests on building materials and structures Part 20: Method for the determination of the fire resistance of elements of construction (general principles), BSI London, 1987. This standard refers to the ISO834 Fire Curve.

*Calculated value based on empirical evidence

**Fire Fastener needed when used in a 'u' orientation (i.e. channel side up)

***Gripple Universal Bracket, Low Profile Bracket and Fast Trak loading values are for uniformly distributed load (UDL)

† Refer to Hilti Direct Fastening Technology Manual 2015 for fire resistance details

Key	
-	End Fixing unavailable
∅	F30, F60, F90 and F120 available
o	F30, F60, F90 and only

www.gripple.com

info@gripple.com

Gripple Ltd (Headquarters)

The Old West Gun Works
Savile Street East
Sheffield S4 7UQ
UK

T | +44 (0) 800 018 4264

F | +44 (0) 114 275 1155

E | info@gripple.com

Gripple Europe SARL

1, rue du Commerce
BP 37
67211 Obernai Cedex
France

T | +33 (0)3 88 95 44 95

F | +33 (0)3 88 95 08 78

E | frinfo@gripple.com

Gripple Inc

1611 Emily Lane
Aurora
IL 60502
USA

T | +1 866 474 7753

F | +1 800 654 0689

E | grippleinc@gripple.com

Gripple India

C-115, Industrial Area
Phase I, Naraina
New Delhi-110028
India

T | +91 11-40582703

F | +91 11-40582703

E | ininfo@gripple.com

Gripple Canada Inc

7015 Ordan Drive
Unit #15 Mississauga
Ontario L5T 1Y2
Canada

T | +1 905 458 8700

F | +1 800 654 0689

E | cainfo@gripple.com

Gripple Japan K.K

2-57 Tsukizi-cho
Hyogo-ku, Kobe-shi
Hyogo, 652-0845
Japan

T | +81 (0) 78 681 2121

F | +81 (0) 78 681 2122

E | japan@gripple.com



A GLIDE company



BROC-FAST-ENG

Published September 2021

Please refer to www.gripple.com for the most up to date user advice and product information.



© 2021 Gripple.

Gripple is a registered trademark of Gripple Limited.
Company registered in England No. 1772901, VAT Reg No. GB 600 1951 88