

# Quiet Pack (QP)

- 'O' Class rated acoustically treated casing, ensuring minimum duct and breakout noise levels
- Air volumes up to 1.59m<sup>3</sup>/s
- Suitable for external pressures up to 500Pa
- Designed to suit duct diameters from 100 to 500mm
- Operating Temperatures from -15°C up to +40°C
- Speed Controllable
- Quality Assurance to BS EN ISO 9001:1994
- Performance tested to BS848 Part 1 1980

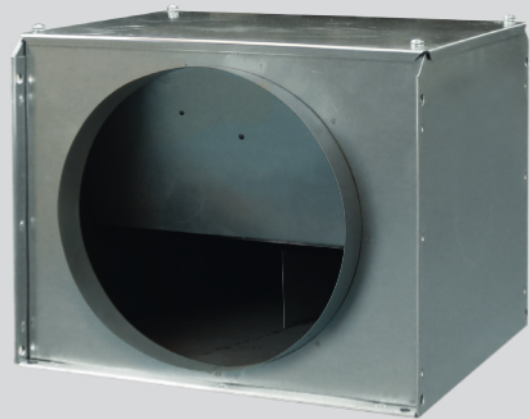

The Quiet Pack in-line acoustic fans are as supplied from Roof Units, designed around a high performance centrifugal impeller, offering a highly efficient, quiet and compact in-line acoustic fan.

The Quiet Pack fan range is manufactured from prime quality galvanised sheet steel, ensuring a robust in-line fan for those tough site conditions.

Quiet Pack casings are suitable for internal mounting and internally treated with an 'O' class rated acoustic foam, which offers the benefits of excellent low level duct bound and breakout sound levels, in addition self extinguishing properties, zero burn rate, resistant to ignition, and no toxic fumes.

Quiet Pack fans are suitable for circular ducting ranging in sizes 100, 125, 150, 160, 200, 250, 315, 400 and 500mm, with air volumes from 0.016m<sup>3</sup>/s to 1.8m<sup>3</sup>/s and pressure development of up to 500Pa.

The casing are specially designed to allow the unit to be mounted via drop rods or anti vibration mounts, ensuring a quick and easy solution to installation of the Quiet Pack in-line acoustic fans. All manufacturing processes of the Quiet Pack fan units are computer designed and controlled to BS EN ISO 9001 Standards.

---

## Impellers

The motor and backward curved impeller is factory matched, statically and dynamically balanced on precision machines, to DIN ISO 1940 Grade 6.3, to give quiet, vibration free running.

---

## Motors

Motor insulation Class B, suitable for operating temperatures from -15°C to +40°C and atmospheres up to 95% RH.

All sizes are ideally suitable for speed control by electronic or voltage reduction. Vent-Axia would recommend that a voltage reduction Auto Transformer speed controller is used with all Quiet Pack units to ensure minimum noise levels during speed control and to eliminate any possibility of harmonic noise levels which may occur when using electronic speed controllers at lower speeds.

---

## Performance

The fan performance is in accordance with tests to BS848 Part 1 1980, with the fan sound levels measured in a reverberant chamber in accordance with BS848 Part 2 1985.

---

## Quality Assurance

Design and manufacture is in accordance with the standard for quality management systems BS EN ISO 9001:1994.

---

## Accessories

A full range of accessories are available with the Fan Box range of fans such as:

- Auto Transformer Speed Controllers
- Electronic Speed Controllers
- D.O.L. Starters
- Standard, Acoustic & Thermal Flexible Ducting
- Pre-Panel or Secondary Bag Filters
- Electric Heater Batteries
- Backdraught Shutters
- In-Line Attenuators
- Wall & Roof Terminals
- Fast Clamps

## Dimensions (mm)

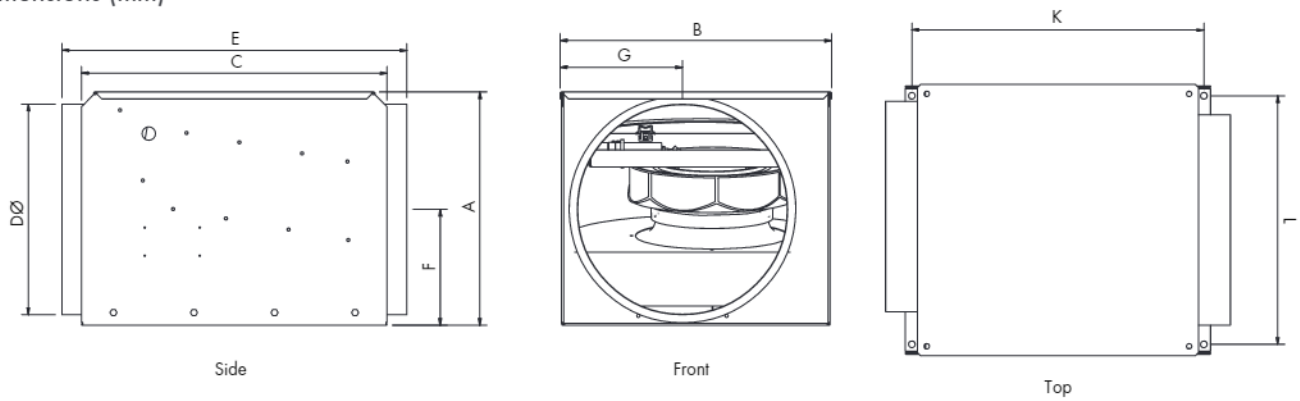

| Stock Ref | A   | B   | C   | ØD  | E    | F   | G   | K   | L   | kg |
|-----------|-----|-----|-----|-----|------|-----|-----|-----|-----|----|
| QP100C    | 190 | 310 | 400 | 100 | 460  | 94  | 111 | 380 | 275 | 11 |
| QP125C    | 190 | 310 | 400 | 125 | 460  | 94  | 111 | 380 | 275 | 11 |
| QP150C    | 190 | 310 | 400 | 150 | 460  | 94  | 111 | 380 | 275 | 11 |
| QP160C    | 190 | 310 | 400 | 160 | 460  | 94  | 111 | 380 | 275 | 11 |
| QP200C    | 285 | 364 | 455 | 200 | 515  | 141 | 127 | 435 | 330 | 17 |
| QP250C    | 285 | 364 | 455 | 250 | 515  | 141 | 127 | 435 | 330 | 17 |
| QP315C    | 456 | 572 | 730 | 315 | 792  | 227 | 243 | 710 | 540 | 45 |
| QP400C    | 456 | 572 | 730 | 400 | 792  | 227 | 243 | 710 | 540 | 46 |
| QP500C    | 575 | 769 | 918 | 500 | 1006 | 286 | 326 | 898 | 735 | 77 |

## Anti Vibration Mountings

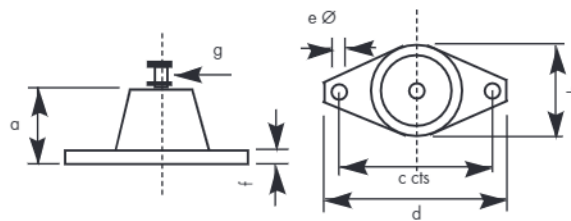

| Stock Ref | a  | b  | c  | d  | eØ | f | g  |
|-----------|----|----|----|----|----|---|----|
| 68MPO33G  | 27 | 37 | 54 | 67 | 7  | 3 | M8 |

# Performance Guide

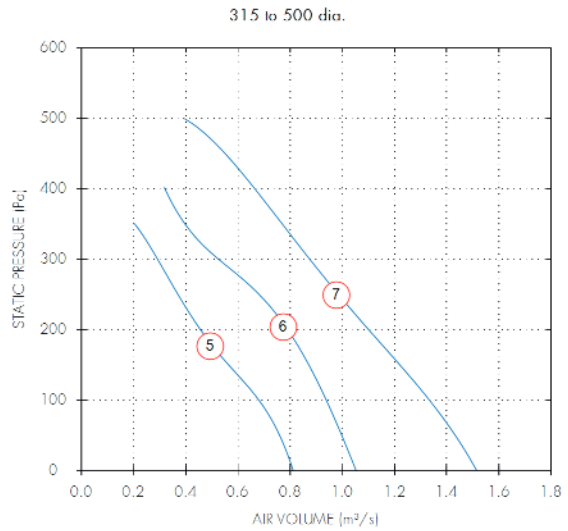
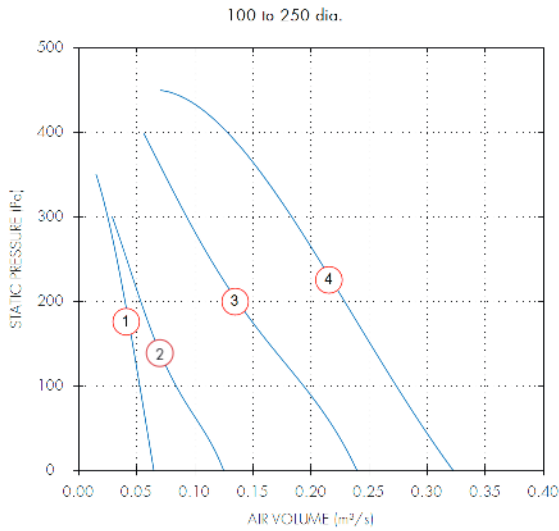

| Dia. | Motor Phase | Stock Ref | r.p.m | Curve Ref. | m³/s @ Pa |      |      |      |      | Motor kW | S.C. Amps | F.L.C Amps | dB(A) @ 3m |
|------|-------------|-----------|-------|------------|-----------|------|------|------|------|----------|-----------|------------|------------|
|      |             |           |       |            | 0         | 100  | 200  | 300  | 400  |          |           |            |            |
| 100  | 1           | QP100C    | 2350  | 1          | 0.06      | 0.05 | 0.04 | 0.03 |      | 0.05     | 0.37      | 0.23       | 32         |
| 125  | 1           | QP125C    | 2350  | 1          | 0.07      | 0.05 | 0.04 | 0.02 |      | 0.05     | 0.37      | 0.23       | 33         |
| 150  | 1           | QP150C    | 2350  | 2          | 0.12      | 0.08 | 0.05 | 0.03 |      | 0.05     | 0.37      | 0.23       | 33         |
| 150  | 1           | QP160C    | 2350  | 2          | 0.12      | 0.08 | 0.05 | 0.03 |      | 0.05     | 0.37      | 0.23       | 33         |
| 200  | 1           | QP200C    | 2700  | 3          | 0.24      | 0.19 | 0.14 | 0.09 |      | 0.09     | 0.85      | 0.38       | 36         |
| 250  | 1           | QP250C    | 2500  | 4          | 0.32      | 0.27 | 0.23 | 0.18 | 0.13 | 0.16     | 1.25      | 0.68       | 36         |
| 315  | 1           | QP315C    | 1330  | 5          | 0.81      | 0.68 | 0.46 | 0.29 |      | 0.27     | 2.2       | 1.18       | 38         |
| 400  | 1           | QP400C    | 1340  | 6          | 1.05      | 0.94 | 0.79 | 0.53 | 0.32 | 0.47     | 5.9       | 2.33       | 39         |
| 500  | 1           | QP500C    | 1330  | 7          | 1.52      | 1.33 | 1.1  | 0.88 | 0.66 | 0.73     | 6.27      | 3.21       | 47         |

## Sound Power Level Spectra dB (ref 10<sup>-12</sup> Watts)

| Dia. | Motor Phase | Stock Ref | Spectrum | dB(A) @ 3m |     |     |     |    |    |    |    |    |
|------|-------------|-----------|----------|------------|-----|-----|-----|----|----|----|----|----|
|      |             |           |          | 63         | 125 | 250 | 500 | 1k | 2k | 4k | 8k |    |
| 100  | 1           | QP100C    | Inlet    | 53         | 59  | 68  | 58  | 50 | 45 | 34 | 33 | 41 |
| 100  | 1           | QP100C    | Outlet   | 54         | 57  | 63  | 59  | 60 | 54 | 49 | 42 | 43 |
| 100  | 1           | QP100C    | Breakout | 48         | 52  | 59  | 49  | 41 | 39 | 31 | 32 | 32 |
| 125  | 1           | QP125C    | Inlet    | 51         | 65  | 73  | 62  | 51 | 46 | 36 | 36 | 45 |
| 125  | 1           | QP125C    | Outlet   | 52         | 62  | 67  | 64  | 62 | 55 | 52 | 45 | 46 |
| 125  | 1           | QP125C    | Breakout | 51         | 53  | 60  | 49  | 41 | 40 | 33 | 33 | 33 |
| 150  | 1           | QP150C    | Inlet    | 54         | 60  | 70  | 59  | 52 | 46 | 38 | 36 | 42 |
| 150  | 1           | QP150C    | Outlet   | 56         | 58  | 63  | 58  | 59 | 56 | 49 | 43 | 43 |
| 150  | 1           | QP150C    | Breakout | 50         | 55  | 60  | 50  | 43 | 38 | 31 | 32 | 33 |
| 160  | 1           | QP160C    | Inlet    | 54         | 60  | 70  | 59  | 52 | 46 | 38 | 36 | 42 |
| 160  | 1           | QP160C    | Outlet   | 56         | 58  | 63  | 58  | 59 | 56 | 49 | 43 | 43 |
| 160  | 1           | QP160C    | Breakout | 50         | 55  | 60  | 50  | 43 | 38 | 31 | 32 | 33 |
| 200  | 1           | QP200C    | Inlet    | 60         | 65  | 63  | 68  | 58 | 55 | 54 | 46 | 46 |
| 200  | 1           | QP200C    | Outlet   | 60         | 63  | 68  | 72  | 68 | 67 | 62 | 53 | 53 |
| 200  | 1           | QP200C    | Breakout | 54         | 58  | 60  | 57  | 46 | 41 | 35 | 34 | 36 |
| 250  | 1           | QP250C    | Inlet    | 64         | 74  | 72  | 67  | 57 | 55 | 56 | 53 | 48 |
| 250  | 1           | QP250C    | Outlet   | 64         | 74  | 75  | 69  | 70 | 71 | 65 | 64 | 56 |
| 250  | 1           | QP250C    | Breakout | 52         | 57  | 68  | 52  | 44 | 40 | 36 | 38 | 39 |
| 315  | 1           | QP315C    | Inlet    | 66         | 78  | 68  | 60  | 52 | 49 | 42 | 40 | 45 |
| 315  | 1           | QP315C    | Outlet   | 67         | 75  | 77  | 71  | 69 | 62 | 56 | 49 | 53 |
| 315  | 1           | QP315C    | Breakout | 54         | 70  | 63  | 53  | 47 | 41 | 35 | 34 | 38 |
| 400  | 1           | QP400C    | Inlet    | 73         | 82  | 79  | 68  | 62 | 55 | 50 | 49 | 52 |
| 400  | 1           | QP400C    | Outlet   | 72         | 78  | 78  | 75  | 74 | 66 | 58 | 53 | 57 |
| 400  | 1           | QP400C    | Breakout | 57         | 71  | 63  | 56  | 51 | 46 | 39 | 35 | 39 |
| 500  | 1           | QP500C    | Inlet    | 77         | 85  | 78  | 71  | 64 | 62 | 54 | 52 | 54 |
| 500  | 1           | QP500C    | Outlet   | 74         | 83  | 82  | 78  | 77 | 72 | 64 | 58 | 61 |
| 500  | 1           | QP500C    | Breakout | 68         | 81  | 72  | 63  | 56 | 49 | 42 | 41 | 48 |

## Models & Accessories

| Fan<br>Stock Ref | Speed Controller        |                   |                      | Overload<br>Stock Ref | Anti Vibration<br>Mounts (set of 4)<br>Stock Ref |
|------------------|-------------------------|-------------------|----------------------|-----------------------|--|
|                  | Electronic<br>Stock Ref | Auto<br>Transfor. | Starter<br>Stock Ref |                       |  |
| QP100C           | SP5001                  | SPM5020           | 444744               | 444699                | 68MP033G   |
| QP125C           | SP5001                  | SPM5020           | 444744               | 444699                | 68MP033G   |
| QP150C           | SP5001                  | SPM5020           | 444744               | 444699                | 68MP033G   |
| QP160C           | SP5001                  | SPM5020           | 444744               | 444699                | 68MP033G   |
| QP200C           | SP5001                  | SPM5020           | 444744               | 444699                | 68MP033G   |
| QP250C           | SP5001                  | SPM5020           | 444744               | 444699                | 68MP033G   |
| QP315C           | SP5025                  | SPM5035           | 444744               | 444699                | 68MP033G   |
| QP400C           | SP5050                  | SPM5035           | 444744               | 444699                | 68MP033G   |
| QP500C           | SP5050                  | SPM5060           | 444744               | 444171                | 68MP033G   |

| Fan<br>Stock Ref | Electric<br>Heaters |           | Panel Filters<br>Stock Ref | Bag Filters<br>Stock Ref |
|------------------|---------------------|-----------|----------------------------|--------------------------|
|                  | Stock Ref           | Stock Ref |                            |                          |
| QP100C           | 10531100T1          |           | QPF100A                    | QPFB100A                 |
| QP125C           | 10531125T1          |           | QPF125A                    | QPFB125A                 |
| QP150C           | 10531150T1          |           | QPF150A                    | QPFB150A                 |
| QP160C           | -                   |           | QPF160A                    | QPFB160A                 |
| QP205C           | 10531200T1          |           | QPF200A                    | QPFB200A                 |
| QP250C           | 10531250T1          |           | QPF250A                    | QPFB250A                 |
| QP315C           | 10531315T1          |           | QPF315A                    | QPFB315A                 |
| QP400C           | 10531400T3          |           | QPF400A                    | QPFB400A                 |
| QP500C           | 10531500T3          |           | QPF500A                    | QPFB500A                 |

| Fan<br>Stock Ref | In-line Attenuators |                    |                    |                     | Wall Terminal<br>Stock Ref |
|------------------|---------------------|--------------------|--------------------|---------------------|----------------------------|
|                  | 300mm<br>Stock Ref  | 600mm<br>Stock Ref | 900mm<br>Stock Ref | 1200mm<br>Stock Ref |                            |
| QP100C           | 83010030            | 83010060           | 83010090           | -                   | SA100/280                  |
| QP125C           | 83012030            | 83012060           | 83012090           | -                   | SA125/280                  |
| QP150C           | 83015030            | 83015060           | 83015090           | -                   | SA150/280                  |
| QP160C           | 83016030            | 83016060           | 83016090           | -                   | SA150/280                  |
| QP205C           | -                   | 83020060           | 83020090           | 83020120            | SA200/280                  |
| QP250C           | -                   | 83025060           | 83025090           | 83025120            | SA250/280                  |
| QP315C           | -                   | 83031060           | 83031090           | 83031120            | SA315/280                  |
| QP400C           | -                   | -                  | 83040090           | 83040120            | GSA400/280                 |
| QP500C           | -                   | -                  | 83050090           | 83050120            | -                          |